

# Поворотный рычаг с концевым выключателем

# SES | SIS

## Инструкция по эксплуатации

| Содержание                            | Стр. |
|---------------------------------------|------|
| Инструкция по безопасности .....      | 02   |
| Инструкция по эксплуатации            |      |
| 1. Технические характеристики .....   | 03   |
| 1.1 Использование по назначению       |      |
| 1.2 Работа                            |      |
| 1.3 Технические характеристики        |      |
| 1.4 Материалы                         |      |
| 1.5 Размеры                           |      |
| 2. Установка .....                    | 03   |
| 2.1 Подготовка                        |      |
| 2.2 Механические соединения           |      |
| 2.3 Электрические присоединения ..... | 04   |
| 3. Утилизация .....                   | 04   |
| 3.1 Ввод в эксплуатацию               |      |
| 3.2 Штатная работа                    |      |
| 3.3 Неправильное обращение            |      |
| 4. Техобслуживание и сервис .....     | 04   |
| 4.1 Техобслуживание                   |      |
| 4.2 Сервис                            |      |
| 5. Хранение .....                     | 04   |
| 6. Утилизация .....                   | 04   |







**Детали**

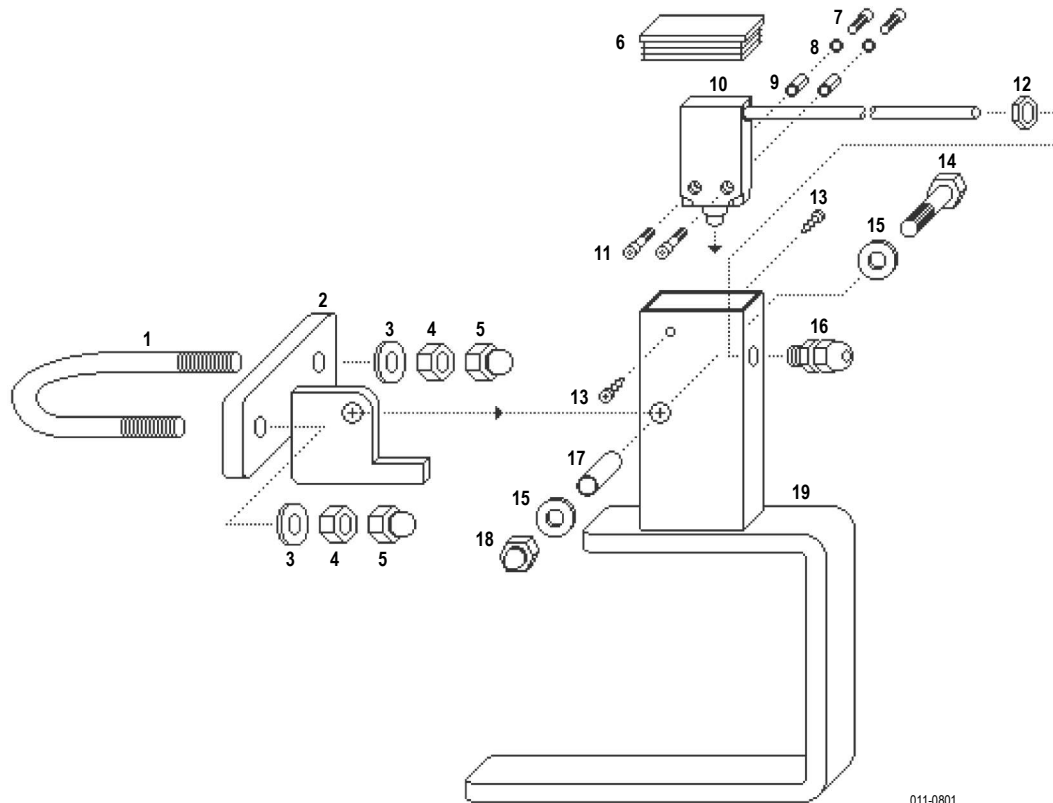

011-0801

| Item | Pcs. | Reference              | Order code      | for size        |
|------|------|------------------------|-----------------|-----------------|
| 1    | 1    | Round steel shackle    | 3570-065-A0-STV | 065             |
|      | 1    | Round steel shackle    | 3570-080-A0-STV | 080             |
|      | 1    | Round steel shackle    | 3570-100-A0-STV | 100             |
|      | 1    | Round steel shackle    | 3570-125-A0-STV | 125             |
|      | 1    | Round steel shackle    | 3570-150-A0-STV | 150             |
| 2    | 1    | Fixing plate           | SES-H065        | 065             |
|      | 1    | Fixing plate           | SES-H080        | 080             |
|      | 1    | Fixing plate           | SES-H100        | 100             |
|      | 1    | Fixing plate           | SES-H125        | 125             |
|      | 1    | Fixing plate           | SES-H150        | 150             |
| 3    | 2    | Washer                 | 0125-12-B00-STV | 065 + 080       |
|      | 2    | Washer                 | 0125-16-B00-STV | 100 + 125 + 150 |
| 4    | 2    | Hexagonal nut          | 0934-12-000-STV | 065 + 080       |
|      | 2    | Hexagonal nut          | 0934-16-000-STV | 100 + 125 + 150 |
| 5    | 2    | Hexagon cap nut        | 0986-12-000-STV | 065 + 080       |
|      | 2    | Hexagon cap nut        | 0986-16-000-STV | 100 + 125 + 150 |
| 6    | 1    | Plug                   | 64286-IF-KST    |                 |
| 7    | 2    | Cylinder head screw    | 0912-04X008-STV |                 |
| 8    | 2    | Snap ring              | 0127-04-B00-V2A |                 |
| 9    | 2    | Hexagonal nut          | 0000-04X010-STV |                 |
| 10   | 1    | E - Limit switch ..... |                 |                 |
|      | 1    | I - Limit switch ..... |                 |                 |
|      | 1    | N - Limit switch ..... |                 |                 |
| 11   | 2    | Cylinder head screw    | 0912-04X012-STV |                 |
| 12   | 1    | Hexagonal nut          | 50.216-PA-JK    |                 |
| 13   | 2    | ABC Spax screw         | 0ABC-04X015-STV |                 |
| 14   | 1    | Hexagon head screw     | 0931-08X040-STV |                 |
| 15   | 2    | Washer                 | 0125-08-B00-STV |                 |
| 16   | 1    | Screwed cable gland    | 50.616-PA-JK    |                 |
| 17   | 1    | Bearing sleeve         | SES-R030        |                 |
| 18   | 1    | Hexagon cap nut        | 0986-08-000-STV |                 |
| 19   | 1    | Swivelling lever       | SES-S002        |                 |

**Order code**

| Cable length 2 m | Cable length 5 m | Cable length 10 m |
|------------------|------------------|-------------------|
| KE-XCM-A110-2    | KE-XCM-A110-5    | KE-XCM-A110-0     |
| KI-XCM-3019-5-2  | KI-XCM-3019-5-5  | KI-XCM-3019-5-0   |
| KN-XCM-NJ4K-5-2  | KN-XCM-NJ4K-5-5  | KN-XCM-NJ4K-5-0   |

# EU-Konformitätserklärung EU-Declaration of Conformity

Wir/We

**MOLLET Füllstandtechnik GmbH**

Industriepark RIO 103  
D-74706 Osterburken  
Tel. 06291 64400 Fax 06291 9846

erklären hiermit, dass die Geräte:

declare that the devices:

**Silo-Überfüllsicherung (silo-safe-system)**  
mit den elektrischen Betriebsmitteln:

**Silo overfill monitoring system (silo-safe-system)**  
with the electrical equipment:

**S-EST ... (elektr. Steuerungen),  
SFA- ..., DF2 ..., HPW ..., HLD ..., MSD-070,  
MSD-A. ..., SEI- ..., SES- ..., SIS- ..., SNS- ...**

**S-EST ... (electrical controller),  
SFA- ..., DF2 ..., HPW ..., HLD ..., MSD-070,  
MSD-A. ..., SEI- ..., SES- ..., SIS- ..., SNS- ...**

auf die sich diese Erklärung bezieht, den folgenden Normen  
oder normativen Dokumenten entsprechen:

to which this declaration relates is in accordance with  
the following standards or other normative documents:

**Richtlinie 2014/35/EU** (NSR-Richtlinie)  
**Richtlinie 2014/30/EU** (EMV-Richtlinie)

**Directive 2014/35/EU** (Directive LVD)  
**Directive 2014/30/EU** (Directive EMC)

und

**DIN EN 61010-1:2011, DIN EN 60529:2014  
DIN EN 61326-1:2013**

and

**DIN EN 61010-1:2011, DIN EN 60529:2014  
DIN EN 61326-1:2013**

Die grundlegenden Sicherheits- und Gesundheitsanforderungen werden erfüllt gemäß den Bestimmungen der Richtlinien und durch Einhaltung der Normen soweit es im Rahmen des Lieferumfangs möglich ist.

The Essential Health and Safety Requirements are assured by compliance with the directive and observance of the normative documents, as far as the scope of delivery allows.

Osterburken, 07. Januar 2020

Osterburken, January 7th 2020



Wolfgang Hageleit

Diese Erklärung darf nur unverändert  
weiterverbreitet werden.

This declaration is only allowed to  
hand out in unchanged form.